

Varennes, January 26th, 2018

Mr. Asterios Sakellaridis
 Aluminco
 Inofita
 Viotia, Greece
 32011

Ref: File no.: AI-04823-B
Preliminary testing results for AAMA/WDMA/CSA 101/I.S.2/A440-11 (NAFS 2011)

Mr. Sakellaridis,

The preliminary summary of results of the tests done in accordance with the requirements for class CW of the AAMA/WDMA/CSA 101/I.S.2/A440-11 Standard is the following:

File no.	AI-04823-B	AB5305
Product type :	Mulled aluminum window (outswing casement and fixed)	
Series/ model:	AL 450	
Dimensions (mm):	2325 x 2340	
Option(s)	None	
NAFS 2011 results:	Positive Design pressure (DP) = 2640 Pa (~55.14 psf) Negative design pressure (DP) = -2640 Pa (~-55.14 psf) Water penetration resistance test pressure = 720 Pa (~15.04 psf) US air infiltration = Passed Canadian air infiltration / exfiltration = A3 Level	
Comment: The tested window specimen will be eligible for a CW-PG55 performance grade if the remaining auxiliary and forced-entry resistance tests are successfully completed.		

The preliminary results presented in this letter are for information purposes only. The final report will contain the official primary and secondary designators, and only these should be used for any publication purposes. Any alteration(s) made to the product in order to achieve these results will be included in the report. The report will contain the complete test sample description, including construction details, sealant details, hardware identification, etc...

The forced-entry resistance test and other auxiliary tests must still be completed in order to determine conformity with the requirements of this standard.

If you need any supplementary information, please do not hesitate to contact the undersigned.

Yours truly,
CLEB laboratory Inc.



Digitally Signed by:

Alexandre Bertrand, Tech.

Encl.: Drawings (Elevation internal side (p.15), Composite Window AL 450 p. 5-7-9)

LABORATORY, FIELD TESTING AND ADVISORY SERVICES FOR THE BUILDING ENVELOPE
 30 YEARS STRONG, UL AND CLEB SERVING CUSTOMERS ACROSS NORTH AMERICA

CHICAGO
 US Headquarters
 750 Anthony Trail
 Northbrook, IL 60062
 chicago@cleb.com

MONTREAL
 Canada Headquarters
 1320 Lionel-Boulet Blvd
 Varennes, QC J3X 1P7
 montreal@cleb.com

QUEBEC
 420 Charest East Blvd
 Suite 300
 Quebec, QC G1K 8M4
 quebec@cleb.com

OTTAWA
 29 Capital Drive
 Suite 200
 Ottawa, ON K2G 0E7
 ottawa@cleb.com

TRURO
 64 Inglis Place
 Suite 203
 Truro, NS B2N 4B4
 truro@cleb.com

NEW YORK
 747 Third Avenue
 2nd Floor
 New York, NY 10017
 newyork@cleb.com

**ELEVATION
(INTERNAL SIDE)**

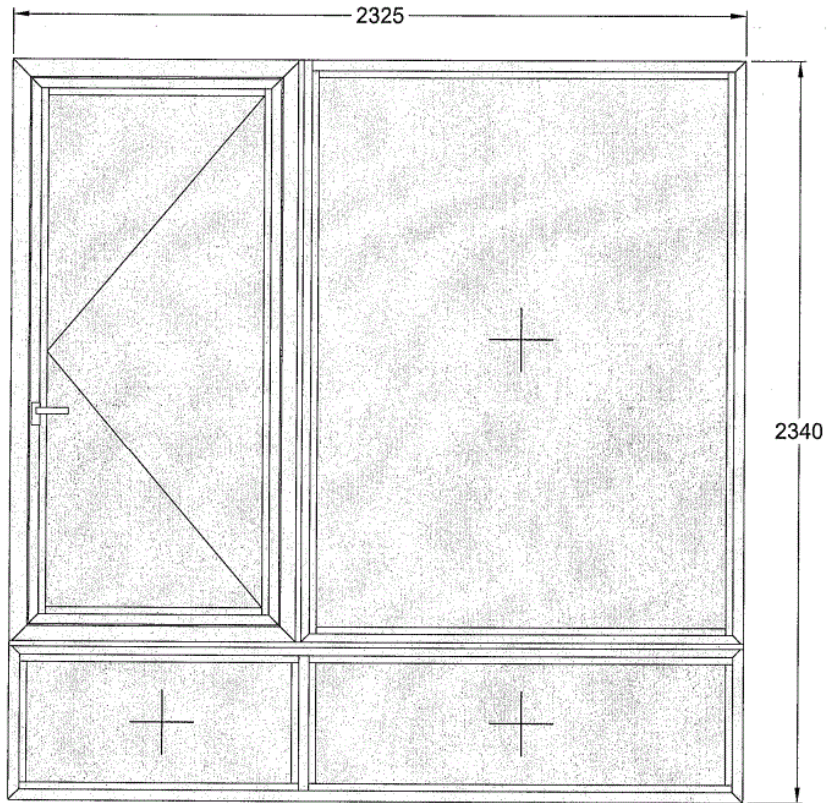

A handwritten signature or mark consisting of several overlapping loops and lines, located in the lower right quadrant of the drawing area.

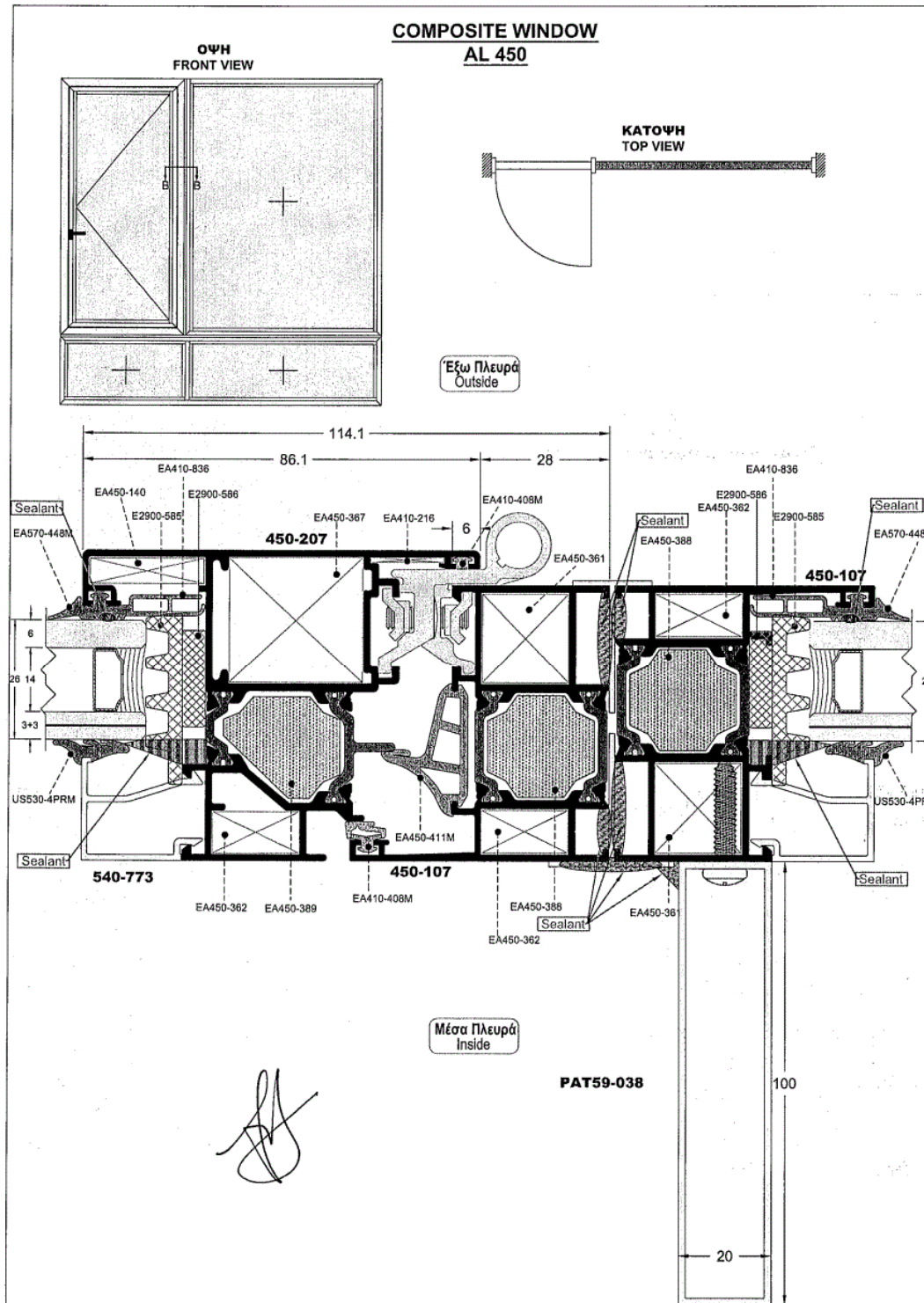

5 of 16

